

Plan Showing The Proposed Layout of House Sites in S.F.No: 394/2, 3 & 4,  
Keeranatham Village And Panchayat, Annur Taluk, Coimbatore District.

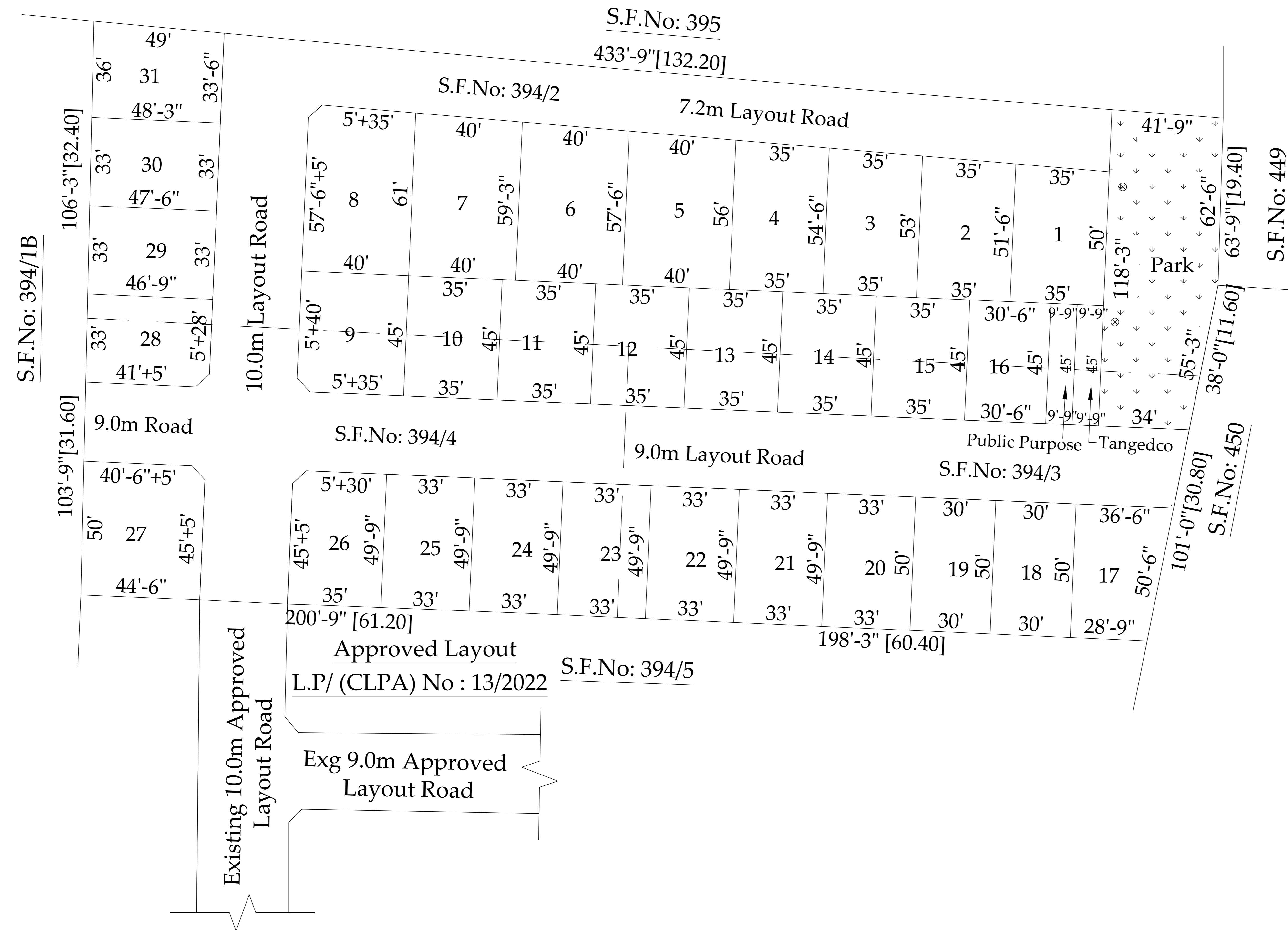
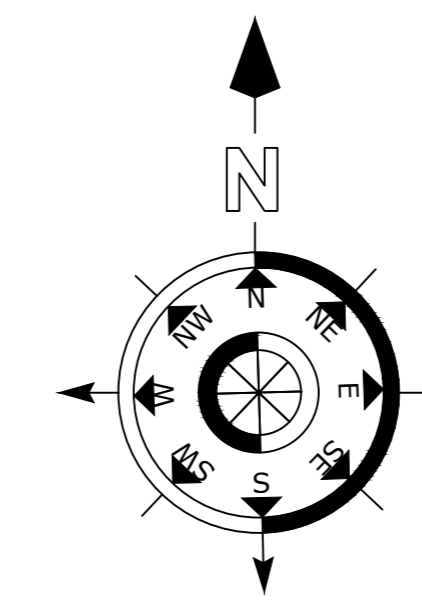

AREA DETAILS			
S.No	Sq.ft	Cent	Sq.ft
1	1776	4	034
2	1829	4	087
3	1881	4	139
4	1934	4	192
5	2270	5	092
6	2335	5	157
7	2405	5	227
8	2458	5	280
9	1788	4	046
10	1575	3	268
11	1575	3	268
12	1575	3	268
13	1575	3	268
14	1575	3	268
15	1575	3	268
16	1373	3	066
17	1631	3	324
18	1500	3	193
19	1500	3	193
20	1646	3	339
21	1642	3	335
22	1642	3	335
23	1642	3	335
24	1642	3	335
25	1642	3	335
26	1733	3	426
27	2238	5	060
28	1518	3	211
29	1555	3	248
30	1580	3	273
31	1690	3	383
Total Area - 54300.00 Sqft			